

Dual DC EMI Filter

3/6A 50V

Two EMI Filters in One Provide Clean EMI-Free DC Power to Your Sensitive Electronics

Switched mode power supplies are at the core of operation of most electronics. The problem is, some of them generate unacceptable levels of electrical noise, otherwise known as conducted electromagnetic interference (EMI), causing operation errors, malfunction and even device damage.

OnFILTER's DC EMI filters block EMI while passing unaltered DC power to your devices. The filters provide good attenuation where you need it—in the spectrum of operation of DC power supplies.

DCNG5003 is two independent EMI filters in one enclosure. Each of these independent filters provides up to 3A DC current; when connected in parallel they provide up to 6A DC current to your load. You can use the filter in multiple supplies environment, or to provide higher-current filtering for a single supply. See the back of this brochure for application examples and for performance data.



Applications

- Industrial control
- Automated tools
- Semiconductor fabrication
- Electronic assembly
- LED lighting
- Wherever EMI is a concern

Features

- Clean DC power
- Superior EMI suppression
- Symmetrical operation
- Two filters in one
- Multiple configurations
- Easy installation

Superior Reduction of EMI from Power Supplies and Lighting

DCNG5003 provides EMI suppression where you need it—across the wide spectrum starting at 10kHz. Common filters start their attenuation only above 100kHz

Two EMI DC Filters in One

DCNG5003 is two independent filters in one allowing use of just one filter for multiple DC supplied, saving space and cost. When connected in parallel, DCNG5003 provides double of current capacity—up to 6A.

Multiple Configurations, One Filter

You can use DCNG5003 in several configurations: two separate filters; one combined filter doubled in current capacity; serial connection of these two filters to boost attenuation at the very low frequencies; or in differential mode providing filtering in both positive and negative supply branch.

Fully Symmetrical Performance

DCNG5003 is completely symmetrical eliminating possibility of connection errors. It provides equal attenuation in both directions, not only reducing EMI from DC supply, but also blocking EMI generated by a noisy load from polluting DC supply for the rest of equipment

DC EMI Filter
DCNG5003
3A/6A 50VDC

BONDLINE
STATIC CONTROL SOLUTIONS



Specification

OnFILTER DC filter DCNG5003 provides substantial reduction in noise from switched mode power supplies and from "noisy" loads protecting proper operation of sensitive electronics.

Parameter TF20101

DRIVE FILTER	
DC Voltage, max.	50VDC
Current, max.	
Single connection	3A
Parallel connection	6A
Nominal DC Resistance	<0.1Ω

Typical Connections

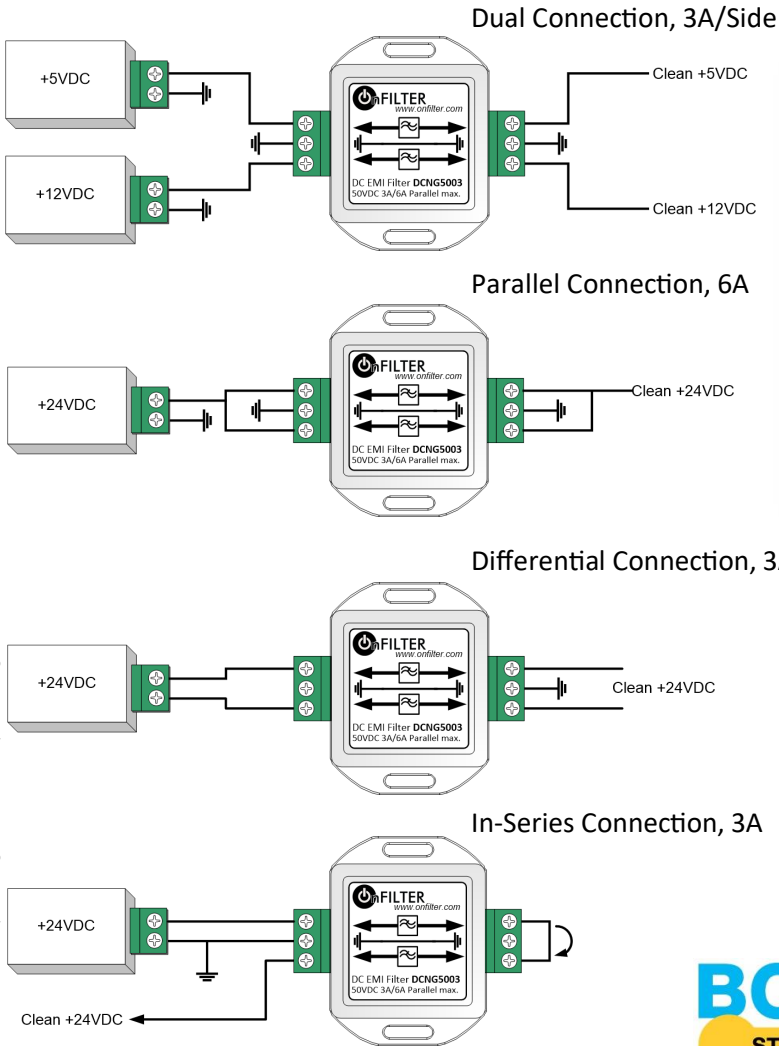

Typical Time-Domain Data

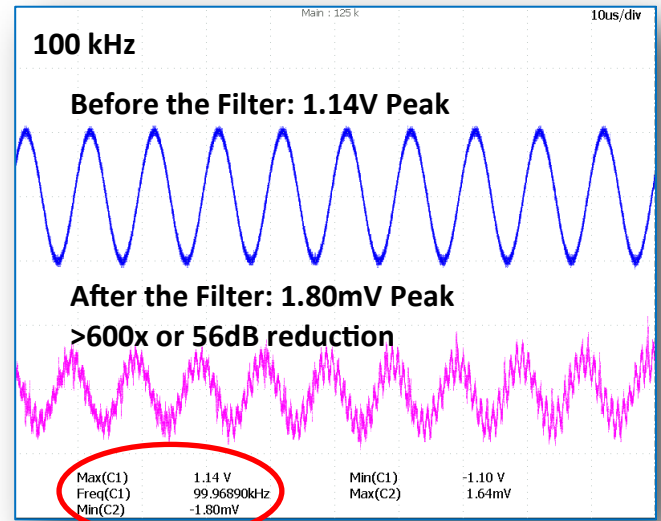

Typical Frequency Domain Data

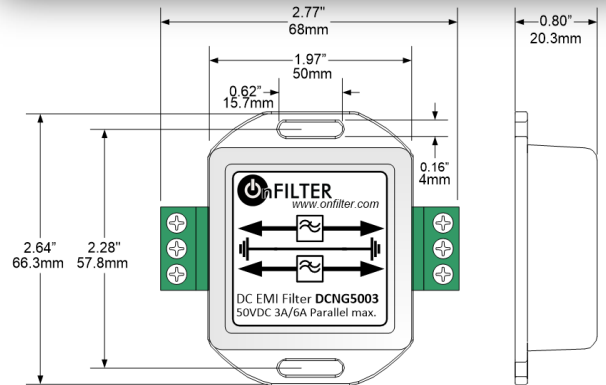
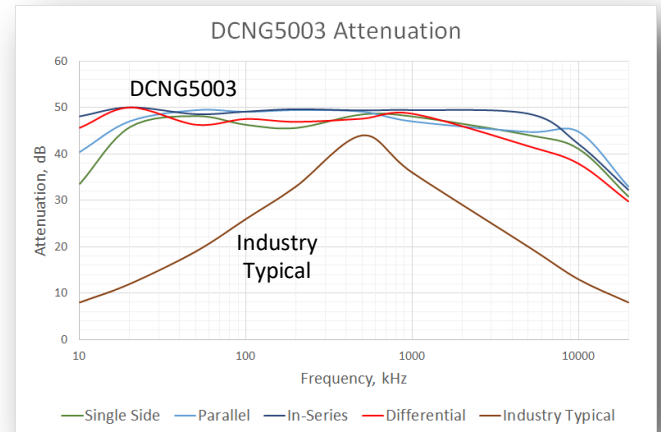

Ordering Information

DC EMI Filter Model: DCNG5003

BONDLINE
STATIC CONTROL SOLUTIONS

www.bondline.com.au
Sales@bondline.com.au
(+61) (02) 9757 3590

OnFILTER

OnFILTER, Inc.
730 Mission Dr. Ste. 102
Santa Cruz, CA 95060 U.S.A.
Tel. +1.831.824.4052
FAX +1.206.350.7458
www.onfilter.com
info@onfilter.com

